



LEFT

One of the brass number plates affixed at each side of the Yonge St. entrance.

ABOVE

The elaborate Romanesque style Yonge St. entrance door; this had a duplicate on the Front St. side of the building, which was blocked off latterly.



RIGHT

General view of 35 Yonge St. looking north-east. The "Stanley Chambers" Annex is visible at the extreme left. The "Round Room" was located on the 6th floor directly under the dome.



ABOVE

14 Front St. East, a building which was originally an additional two storeys in height; the elevator shaft was added by the T. T. C. in fairly recent times.



ABOVE

The Lost Articles Office, 41 Yonge St. only the bottom floor of this building was used during the period of T. T. C. ownership. Part of the one storey extension to Stanley Chambers built in 1953 is visible to the right.

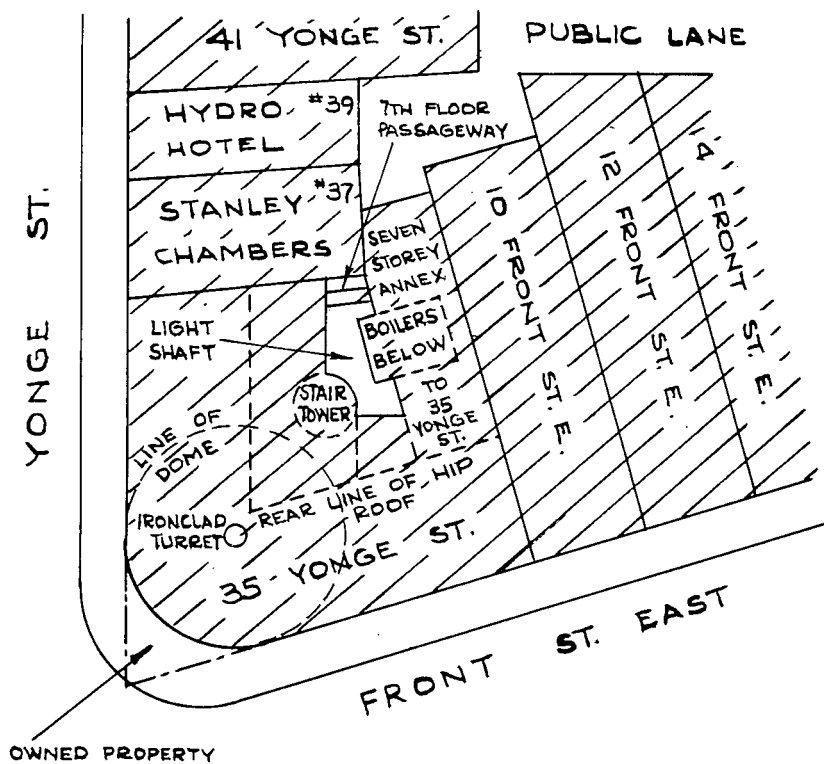
SIW
5-59

35 YONGE ST.
PRIOR TO 1923

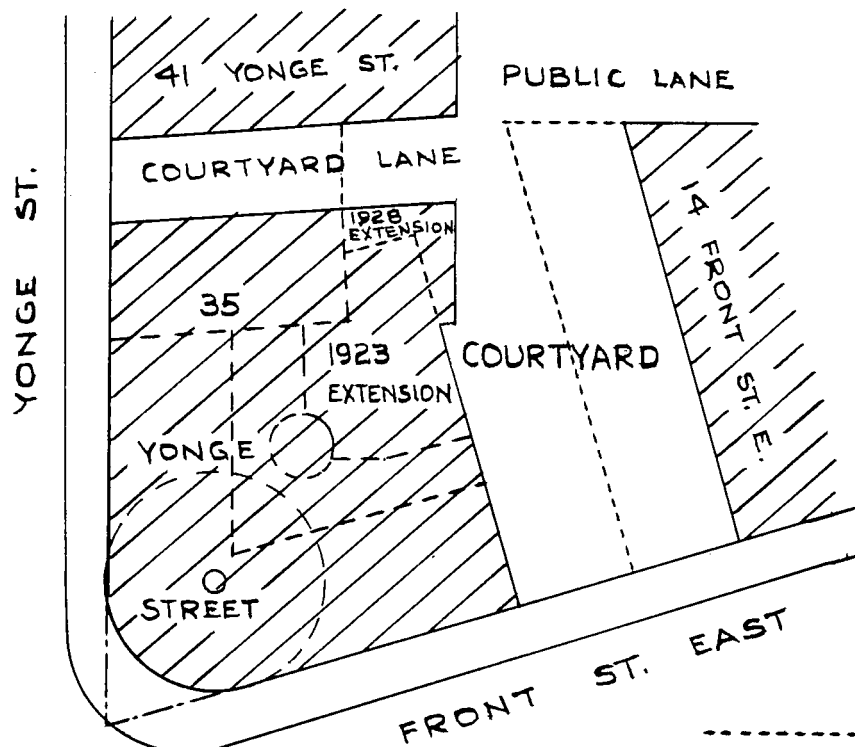

35 YONGE ST.
AFTER 1928

----- INDICATES BUILDING
WALLS IN EXISTENCE
1923-1928

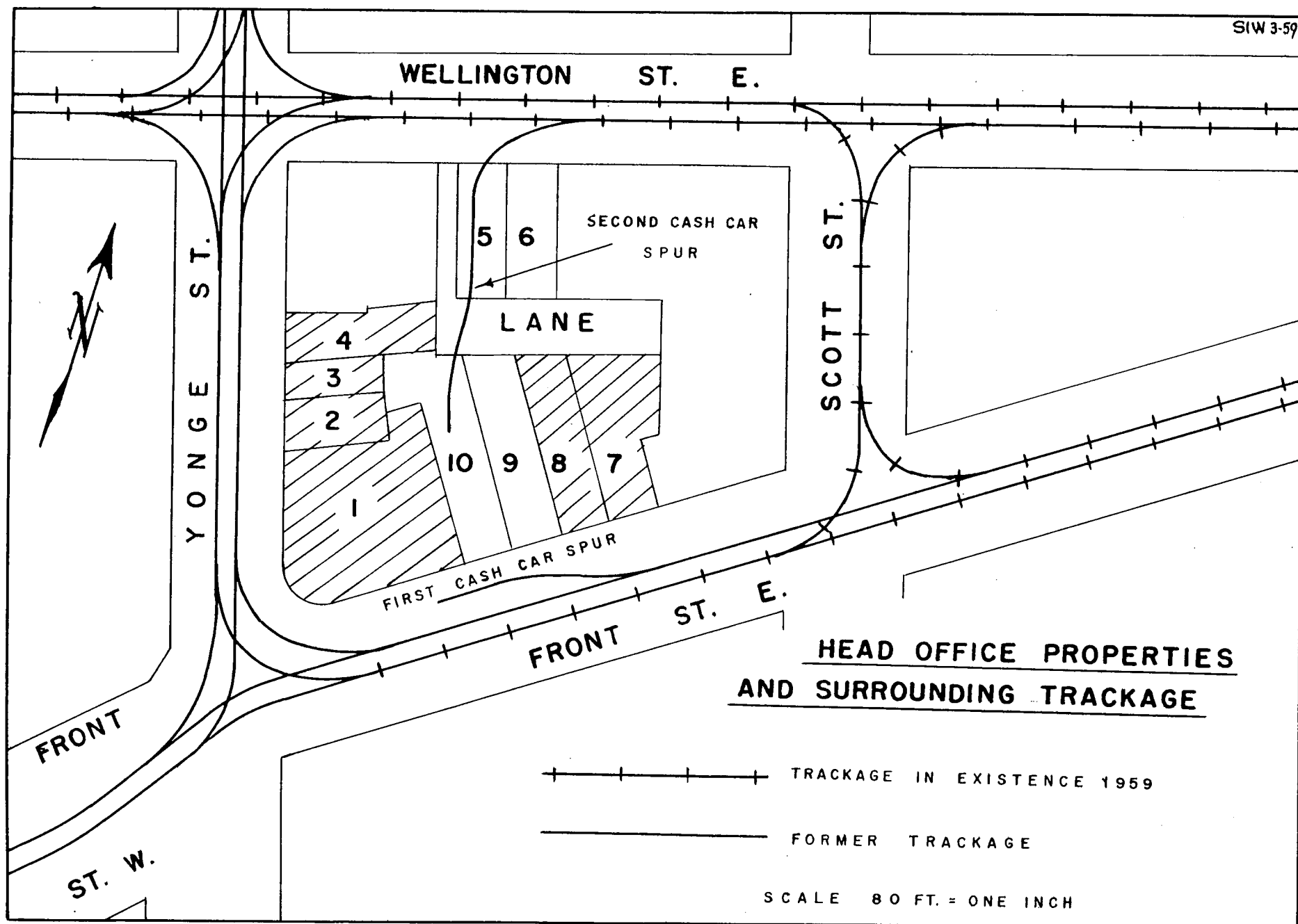

FRONT & YONGE STS:
TORONTO RAILWAY CO.
ROUTES,
JULY 1921

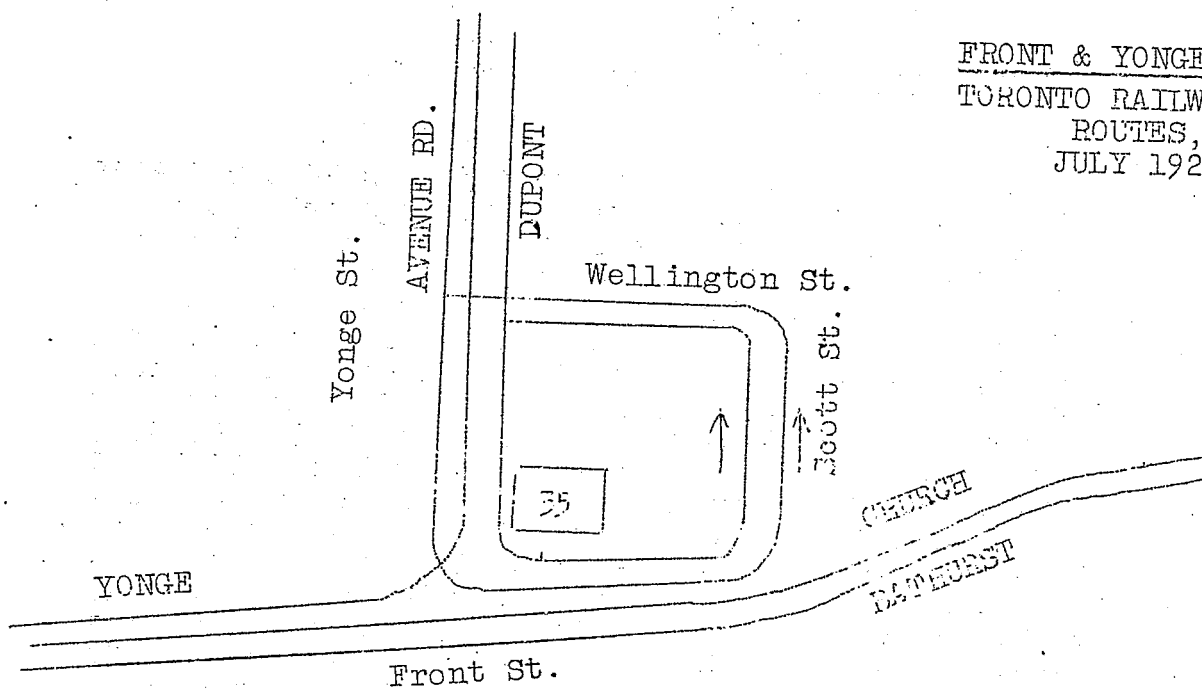

MARCH 1954

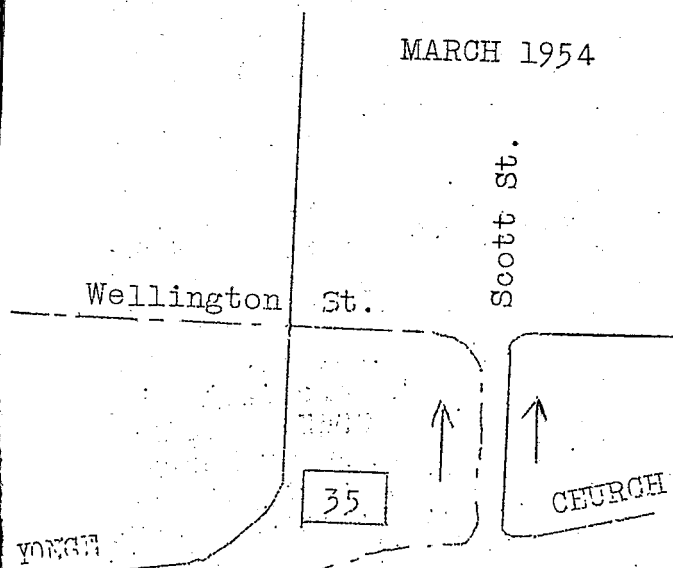

BATHURST TRIPPER
(RUSH HOURS ONLY)

FEBRUARY 1958

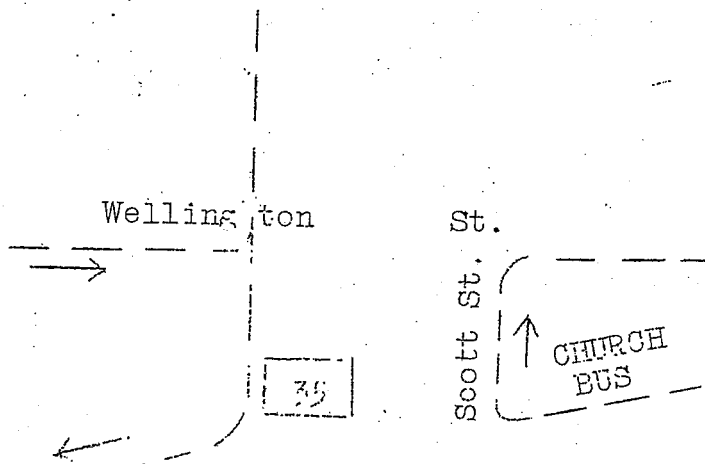

DOWNTOWN
BUS
(BETWEEN RUSH
HOURS ONLY)